

Regupol® 5512 5mm

Impact Sound Acoustic Underlay for Engineered Timber Floors

PRODUCT INFORMATION SHEET



Description

Regupol® 5512 is an impact sound acoustic underlay designed to isolate engineered timber floors from the main structure of the building, reducing impact energy generated by general footfall.

Application

Regupol® 5512 is used under engineered timber floors in most new building constructions including apartments, schools, hospitals, libraries and supermarkets.

Acoustic Performance

TEST: Gabba - TTM	L'nT,w (CI)	FIIIC
Bare slab 150mm concrete	73 (-11)	29
Regupol® 5512 5mm with 14mm Engineered Timber	59 (0)=59	48
Improvement	Δ L'nT,w 14	Δ FIIIC 19

Benefits

- *Independently tested on-site to show it meets the Deemed-to-Satisfy Provisions of the current building regulations in accordance with Building Code of Australia Part F5 .4 Sound Insulation Ratings of Floors (Impact).*
- *Offers long term performance without collapse or bottoming out.*
- *Minimal creep, even under high loads.*
- *Resistant to ageing and deformation.*
- *Quick and easy to install.*
- *Minimises construction heights.*
- *High quality and exact material thickness.*
- *Suitable for use with under floor heating.*
- *Protects expansion joints.*
- *Manufactured and certified to OHAS 18001:1999, DIN ISO 9001:2000, DIN ISO 14001:2004 Management Systems.*

Product Information

Product	Pre-fabricates rolls made from selected SBR rubber rebounded with polyurethane binder.
Roll Width	1.25 metres
Roll Lengths	20 metres
Material Thickness	5mm nominal
Specific Weight	3.50kgs/m ²
Thermal conductivity	0.14 W/mK
Density	700 kgs/m ³
Tensile strength	0.5 N/mm ² (DIN 53571, Specimen B)
Elongation at break	48% (DIN 53571, Specimen B)
Temperature resistance	-40°C to 115°C
Fire classification	B2 (DIN 4102)

NOTICE: The above mentioned test data are based on periodical laboratory testing of test specimen taken from the actual manufacturing process and show the average values measured. The publishing of these technical data does not relieve the user of the necessity to test the relevant product for physical fitness based on a specific application.

Installation Guidelines

Detailed installation guidelines are available upon request.



DISCLAIMER: The above information is given in good faith as a suggested guide in specifying Regupol® Impact Sound Acoustic Underlays, no guarantee or warranty is expressed or implied. Any circumstances not covered by this guide should be referred to Regupol (Australia) Pty Limited or its Distributors for any particular attention required. There are, however, many factors that may affect the outcome of projects using our products that are beyond our control. Regupol (Australia) Pty Limited cannot be responsible for poor climate conditions, inadequate surface preparation, poor application techniques, not observing curing times, improper thinning of adhesives or any variable beyond our control. No liability is accepted by Regupol (Australia) Pty Limited, our employees, distributors, representatives or agents, for any loss or damage, direct or indirect, that may result from using the information and/or suggestions as actual conditions for use that are beyond our control. All materials should be checked/tested for their suitability to the prevailing site conditions.

FLOATING ENGINEERED TIMBER FLOORING WITH REGUPOL® 5512 5MM THICK ACOUSTIC UNDERLAY

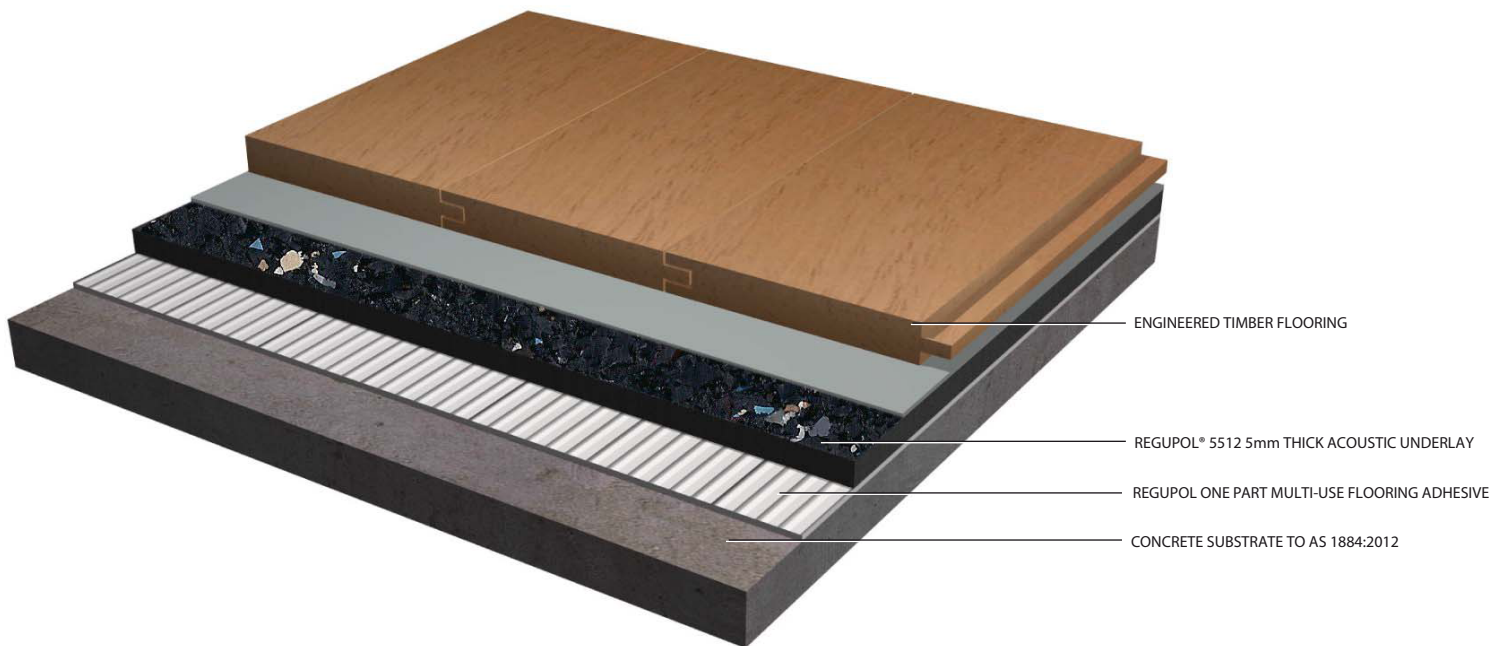

The above system reflects a typical residential application, for all other applications please contact Regupol's Technical Division. Please note that the drawings are not to scale and are for illustration purposes only.

DISCLAIMER: The above information is given in good faith as a suggested guide in specifying Regupol® Impact Sound Acoustic Underlays, no guarantee or warranty is expressed or implied. Any circumstances not covered by this guide should be referred to Regupol (Australia) Pty Limited or its Distributors for any particular attention required. There are, however, many factors that may affect the outcome of projects using our products that are beyond our control. Regupol (Australia) Pty Limited cannot be responsible for poor climate conditions, inadequate surface preparation, poor application techniques, not observing curing times, improper thinning of adhesives or any variable beyond our control. No liability is accepted by Regupol (Australia) Pty Limited, our employees, distributors, representatives or agents, for any loss or damage, direct or indirect, that may result from using the information and/or suggestions as actual conditions for use that are beyond our control. All materials should be checked/tested for their suitability to the prevailing site conditions.

FLOATING ENGINEERED TIMBER FLOORING WITH REGUPOL® 5512 5MM THICK ACOUSTIC UNDERLAY

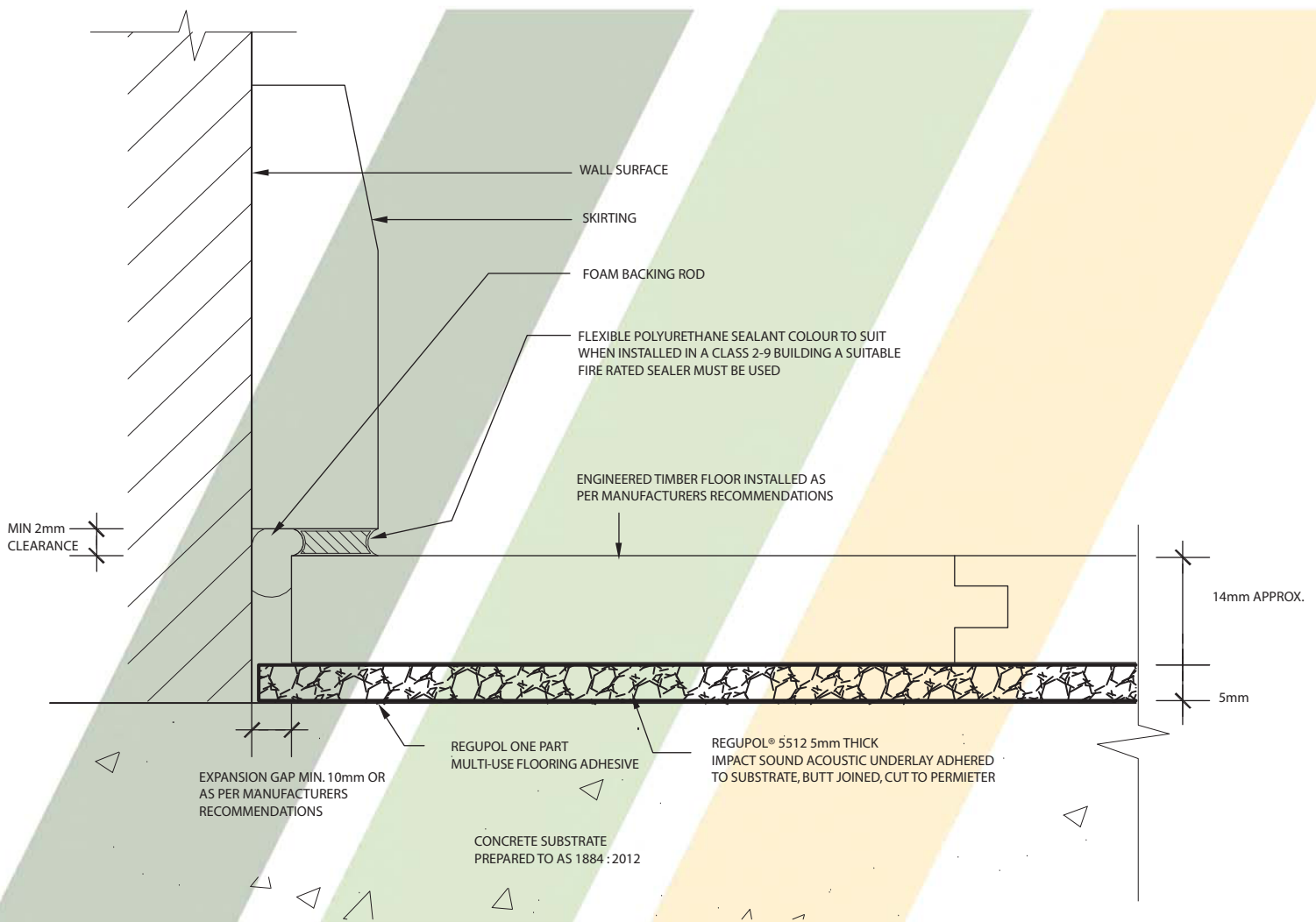

The above system reflects a typical residential application, for all other applications please contact Regupol's Technical Division. Please note that the drawings are not to scale and are for illustration purposes only.

DISCLAIMER: The above information is given in good faith as a suggested guide in specifying Regupol® Impact Sound Acoustic Underlays, no guarantee or warranty is expressed or implied. Any circumstances not covered by this guide should be referred to Regupol (Australia) Pty Limited or its Distributors for any particular attention required. There are, however, many factors that may affect the outcome of projects using our products that are beyond our control. Regupol (Australia) Pty Limited cannot be responsible for poor climate conditions, inadequate surface preparation, poor application techniques, not observing curing times, improper thinning of adhesives or any variable beyond our control. No liability is accepted by Regupol (Australia) Pty Limited, our employees, distributors, representatives or agents, for any loss or damage, direct or indirect, that may result from using the information and/or suggestions as actual conditions for use that are beyond our control. All materials should be checked/tested for their suitability to the prevailing site conditions.

DUAL BOND ENGINEERED TIMBER FLOORING WITH REGUPOL® 5512 5MM THICK ACOUSTIC UNDERLAY

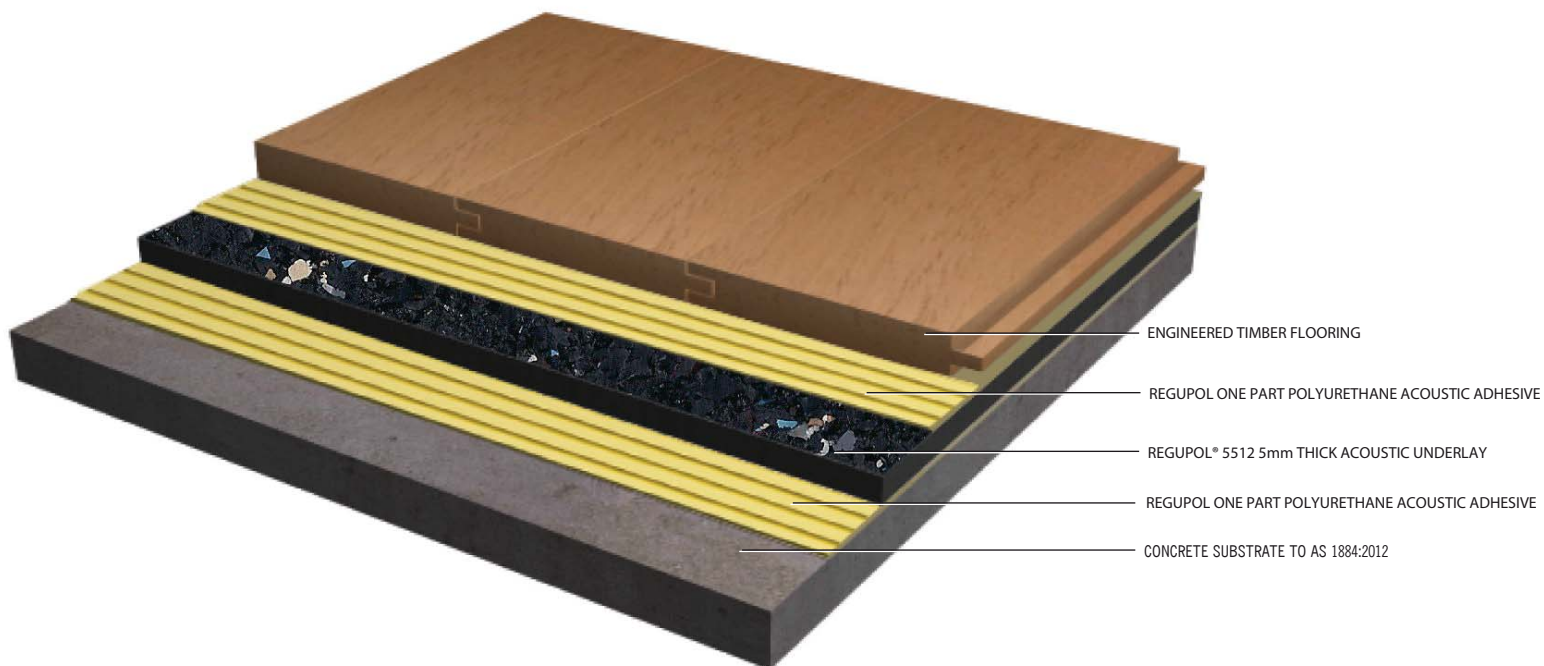

The above system reflects a typical residential application, for all other applications please contact Regupol's Technical Division. Please note that the drawings are not to scale and are for illustration purposes only.

DISCLAIMER: The above information is given in good faith as a suggested guide in specifying Regupol® Impact Sound Acoustic Underlays, no guarantee or warranty is expressed or implied. Any circumstances not covered by this guide should be referred to Regupol (Australia) Pty Limited or its Distributors for any particular attention required. There are, however, many factors that may affect the outcome of projects using our products that are beyond our control. Regupol (Australia) Pty Limited cannot be responsible for poor climate conditions, inadequate surface preparation, poor application techniques, not observing curing times, improper thinning of adhesives or any variable beyond our control. No liability is accepted by Regupol (Australia) Pty Limited, our employees, distributors, representatives or agents, for any loss or damage, direct or indirect, that may result from using the information and/or suggestions as actual conditions for use that are beyond our control. All materials should be checked/tested for their suitability to the prevailing site conditions.

DUAL BOND ENGINEERED TIMBER FLOORING WITH REGUPOL® 5512 5MM THICK ACOUSTIC UNDERLAY

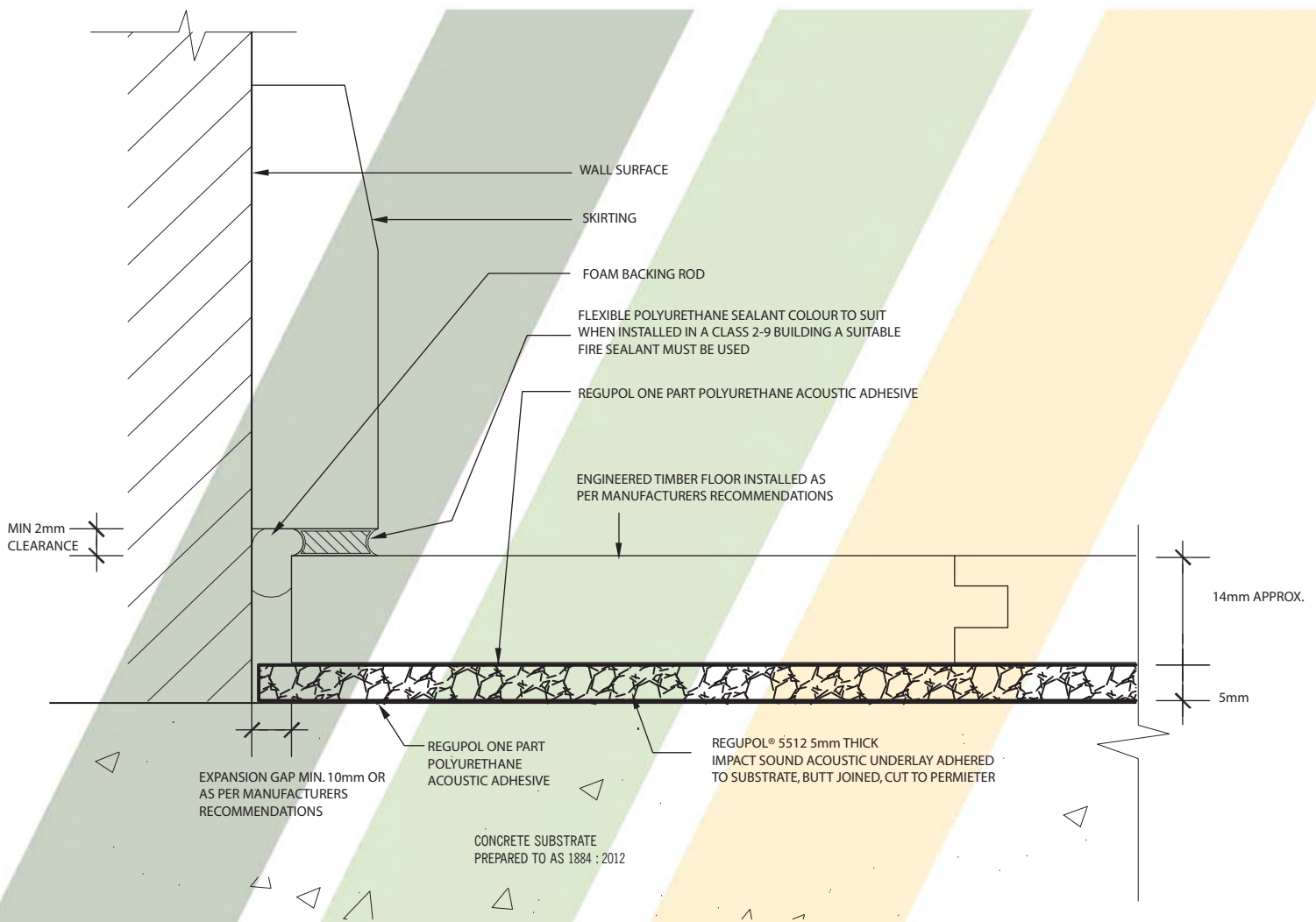

The above system reflects a typical residential application, for all other applications please contact Regupol's Technical Division. Please note that the drawings are not to scale and are for illustration purposes only.

DISCLAIMER: The above information is given in good faith as a suggested guide in specifying Regupol® Impact Sound Acoustic Underlays, no guarantee or warranty is expressed or implied. Any circumstances not covered by this guide should be referred to Regupol (Australia) Pty Limited or its Distributors for any particular attention required. There are, however, many factors that may affect the outcome of projects using our products that are beyond our control. Regupol (Australia) Pty Limited cannot be responsible for poor climate conditions, inadequate surface preparation, poor application techniques, not observing curing times, improper thinning of adhesives or any variable beyond our control. No liability is accepted by Regupol (Australia) Pty Limited, our employees, distributors, representatives or agents, for any loss or damage, direct or indirect, that may result from using the information and/or suggestions as actual conditions for use that are beyond our control. All materials should be checked/tested for their suitability to the prevailing site conditions.